

# How To Do the Rapid Test for Malaria



Collect:

- NEW unopened** test packet
- NEW unopened** spirit swab
- NEW unopened** lancet
- NEW** pair of disposable gloves
- Buffer
- Timer



## READ THESE INSTRUCTIONS CAREFULLY BEFORE YOU BEGIN.

- 1.** Check the expiry date on the test packet.

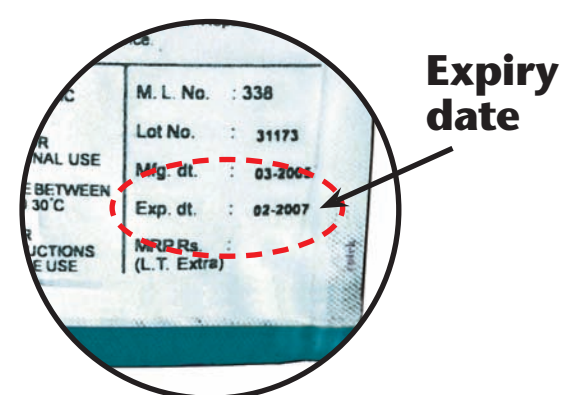

- 2.** Put on the gloves. Use new gloves for each patient



- 3.** Open the packet and remove:

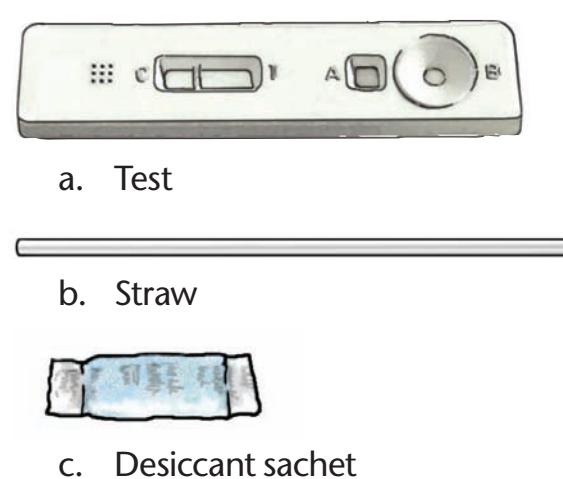

- 4.** Write the patient's name on the test.

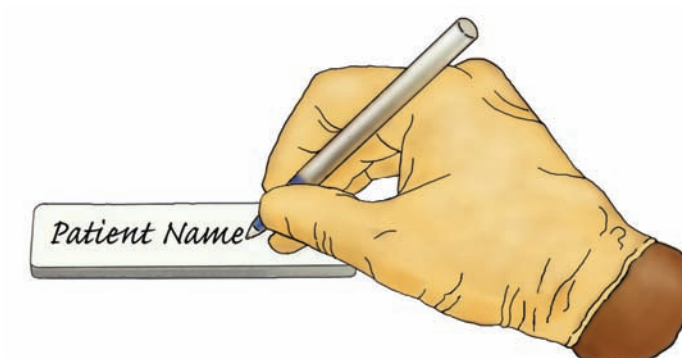

- 5.** Open the alcohol swab. Grasp the 4<sup>th</sup> finger on the patient's left hand. Clean the finger with the spirit swab. Allow the finger to dry before pricking.



- 6.** Open the lancet. Prick patient's finger to get a drop of blood.



- 7.** Discard the lancet in the Sharps Box immediately after pricking finger. **Do not set the lancet down before discarding it.**



- 8.** Use the straw to collect the drop of blood.



- 9.** Use the straw to put the drop of blood into the square hole marked "A."

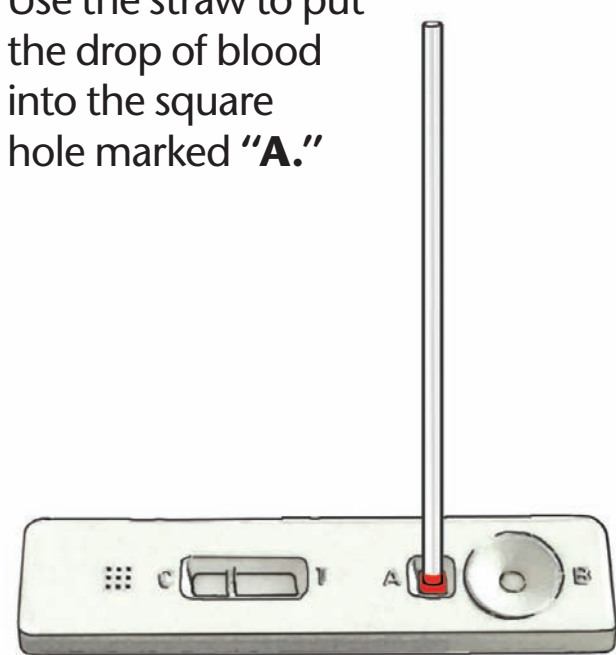

- 10.** Discard the straw in the Sharps Box.



- 11.** Put six (6) drops of buffer into the round hole marked "B."

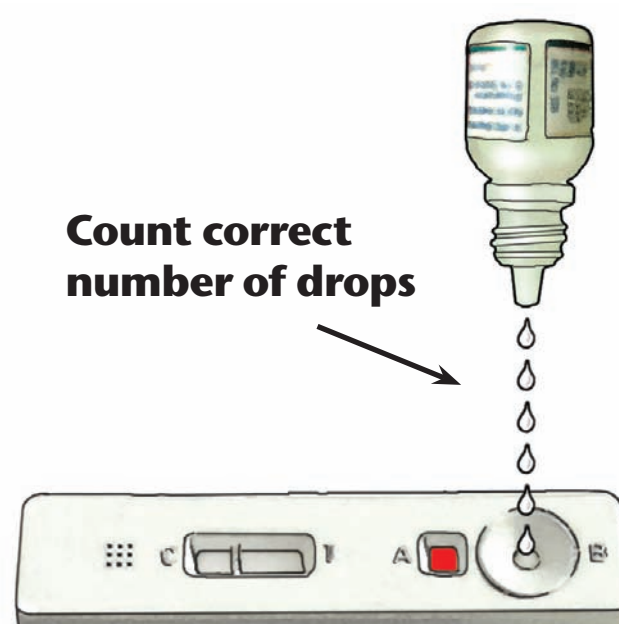

- 12.** Wait **15 minutes** after adding buffer.



- 13.** Read test results. **(NOTE: Do Not** read the test sooner than **15 minutes** after adding the buffer. You may get **FALSE** results.)

- 14.** How to read the test results:

### POSITIVE

One red line in window "C" **AND** one red line in window "T" means the patient **DOES** have *falciparum* malaria.

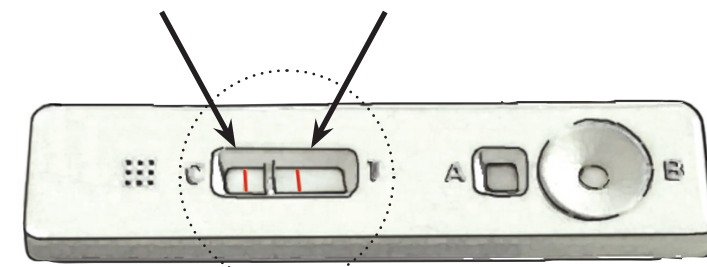

The test is **POSITIVE** even if the red line in window "T" is faint.

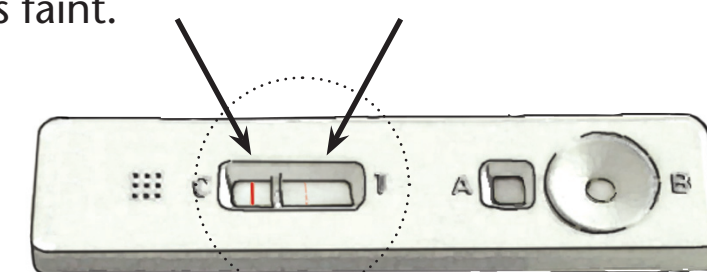

### NEGATIVE

**One red line** in window "C" and **NO LINE** in window "T" means the patient **DOES NOT** have *falciparum* malaria.

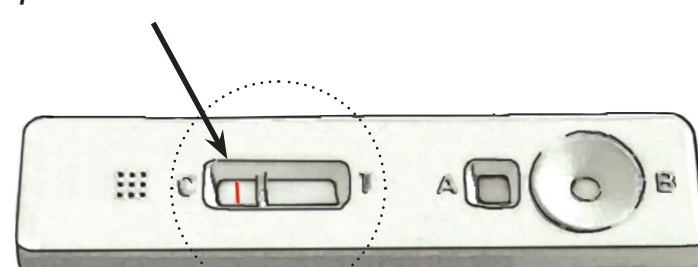

### INVALID RESULT

**NO LINE** in window "C" means the test is damaged.

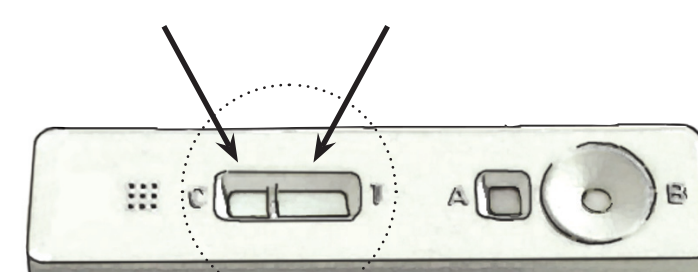

A line in window "T" and **NO LINE** in window "C" also means the test is damaged. Results are **INVALID**.

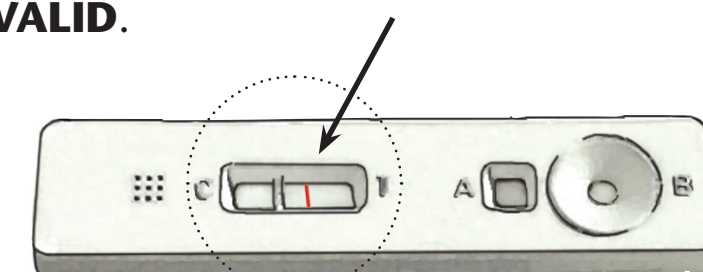

If no line appears in window "C," repeat the test using a **NEW unopened** test packet and a **NEW unopened** lancet.

- 15.** Dispose of the gloves, spirit swab, desiccant sachet and packaging in a non-sharps waste container.



- 16.** Record the test results in your CHW register. Dispose of cassette in non-sharps waste container



**NOTE:** Each test can be used **ONLY ONE TIME**. Do not try to use the test more than once.

